

ANJALLI CONSTRUCTION

Proprietor:-Anjali Paul

Developer

10(7) , 126 K. S. DUTTA ROAD

Ref.....

Date:-

LOCATION DETAILS OF THE PROJECT OF LAND DEDICATED FOR THE PROJECT DEVELOPMENT ALONG WITH ITS BOUNDARIES INCLUDING THE LATITUDE & LONGITUDE OF END POINTS OF THE PROJECT PROJECT:- L.R. DAG NO.-5373/8095,5373/8094 & 5373/8087 , AT MOUZA -DAKSHIN NIMTA,J.L. NO. -8, L.R. KHATIAN NO.-8981,9058 & 9236, P.S.-NIMTA , HOLDING NO.- 12(57) , K M GHOSH ROAD, WARD NO.-8, DIST. - NORTH 24 PARGANAS.UNDER- NORTH DUM DUM MUNICIPALITY .

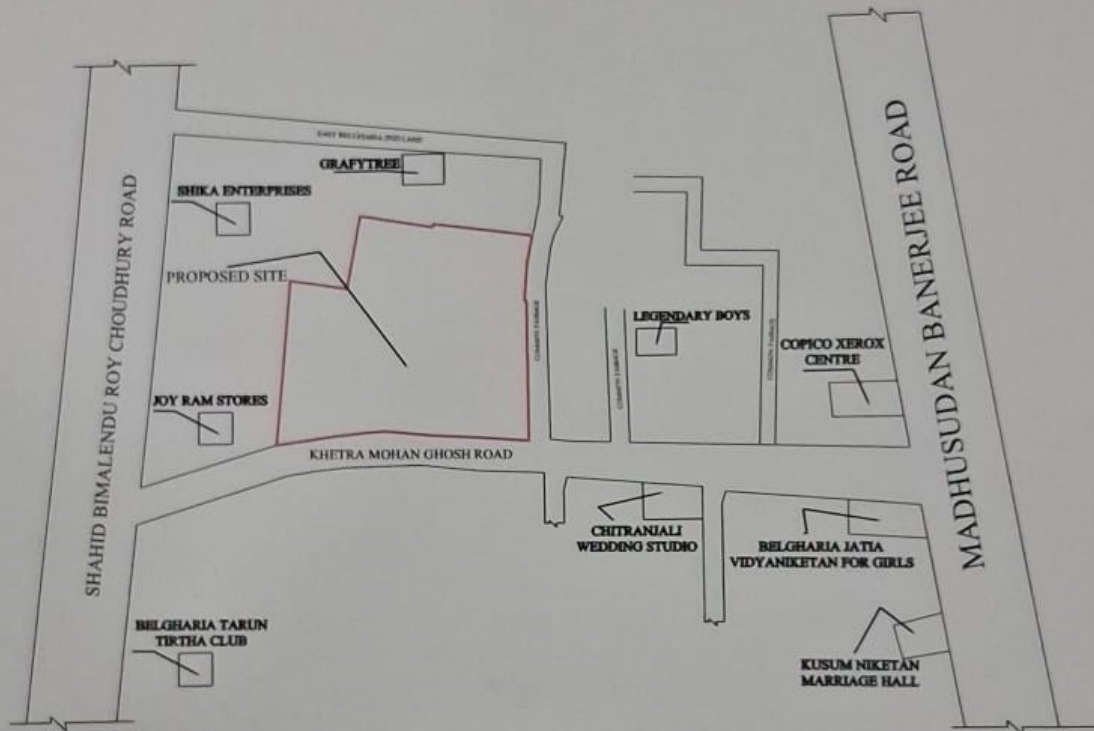

LOCATION PLAN

RAKESH BURMAN
BURMAN ASSOCIATES
ADD:-G.B. Road, Nimta, Kol-49
Plan Maker, Estimator, Surveyor
Licence No.-0917P165122108075

SIGN. OF ENGINEER

LATITUDE : 22.66533

LONGITUDE : 88.39613

